

Developments in the Standardisation of the Core Cadastral Domain Model



Christiaan Lemmen, Paul vander Molen – Kadaster and ITC, The Netherlands

Peter van Osterom, Jaap Zevenbergen and Wilko Quak – Delft University, The Netherlands

Madison, US, June 2005



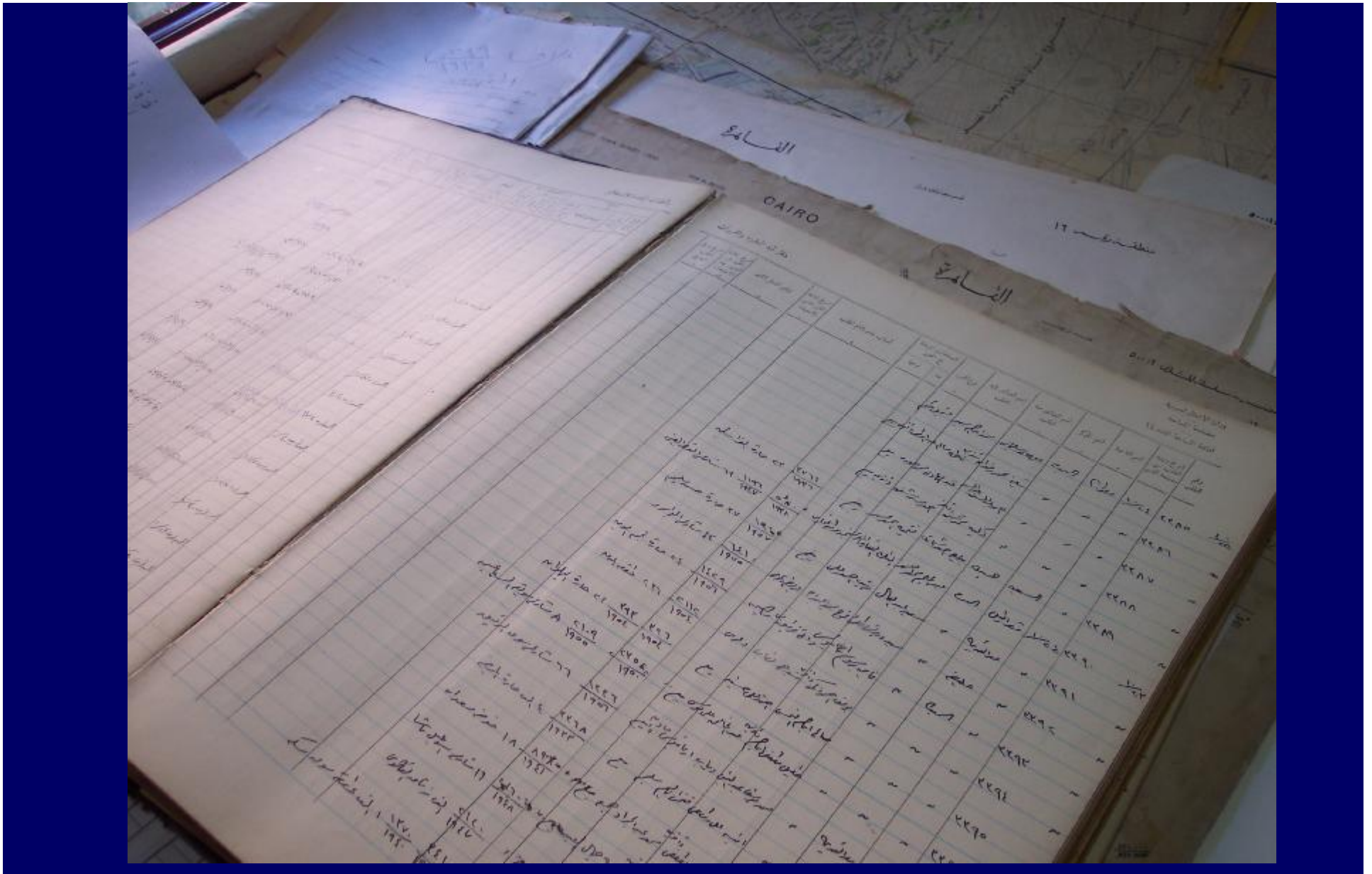

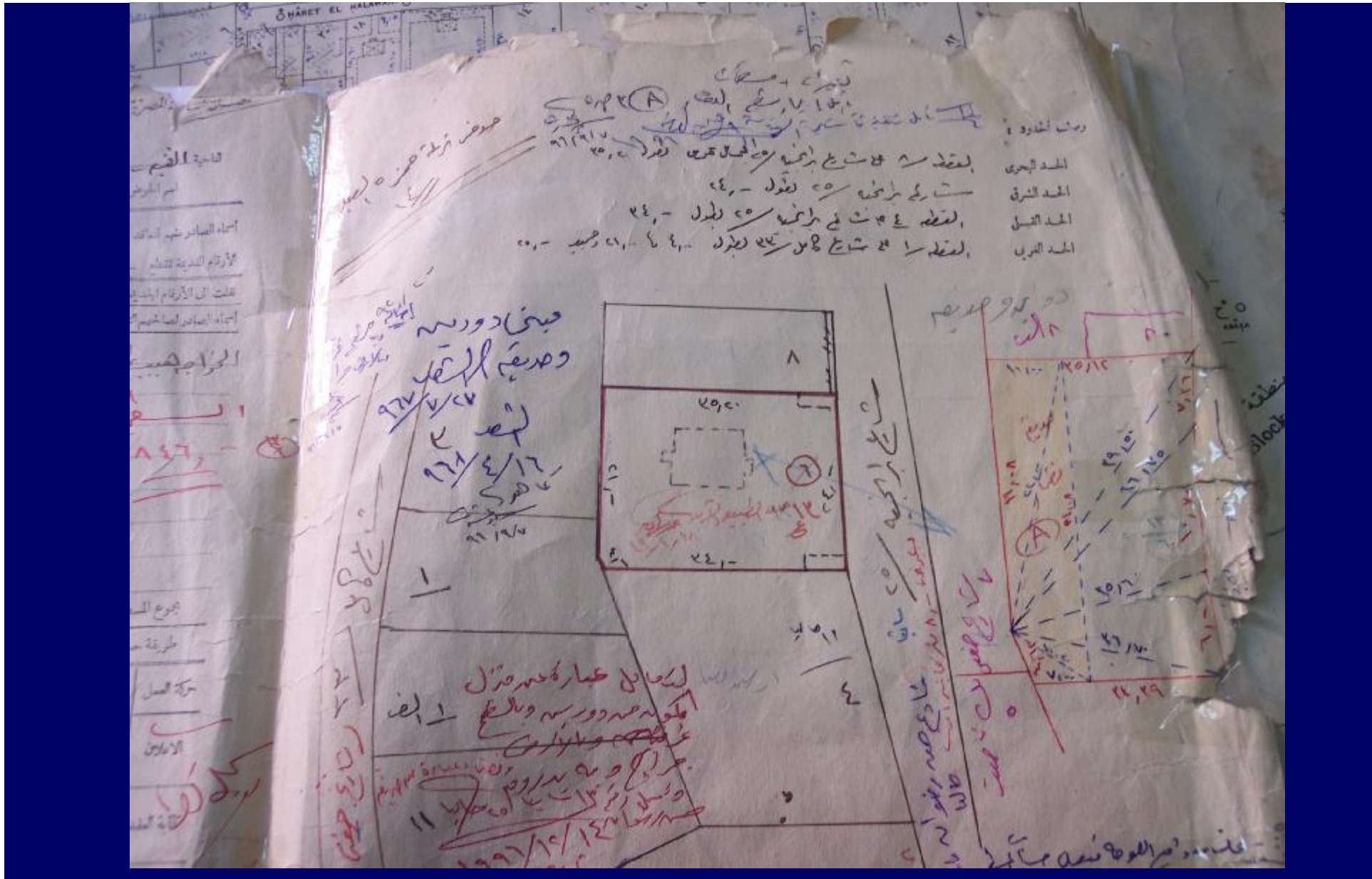

Account No.	Status	Name	Date	1	2	3
A597491	093G	B. Akintayo	8/12/88	1	1	450
A590409	✓	A. Adegbamigbesoull	✓	2	2	✓
A590293	✓	D. M. Obarinji	✓	3	3	✓
A260719	✓	E. O. Soremi	12/12/88	4	4	✓
A590437	✓	A. O. Akintogunde	✓	5	5	✓
A5098	✓	V. A. Awegbun (nee Ojantade)	14/2	6	6	✓
A380A	✓	S. Olaboyade	✓	7	7	✓
A5477	✓	E. O. Adegboye	✓	8	8	✓
A2604	✓	K. Adejumo	15/12	9	9	✓
A5540	✓	H. B. Olatun	15/12	9	9	✓
A5588	-	M. O. Ajayi	16-12-88	10	10	✓
A15415	-	L. O. Olorunfemi	19/12/88	11	11	✓
A15660	✓	B. & F. Isyola	21/12/88	12	12	✓
A5600	✓	E. A. Abimbola	✓	13	13	✓
A5578	✓	O. Okankiri	23/12/88	14	14	✓
A5608	✓	J. A. Alade	✓	15	15	✓
A5547	✓	I. O. Adalunro	28/12/88	16	16	✓
A5530	✓	G. O. Ojo	29/12/88	17	17	✓
A51914	✓					







Agenda

1. Introduction
2. Cadastral Data
3. Generic Cadastral Domain Model
4. Conclusions



Standards

- There are supposed to be huge differences between cadastral and land registry systems
- Look to the common area's:
 - Standardised Model
 - Avoid re-inventing the wheel
 - Enable involved parties to communicate



Standards

- Many countries want to computerise their cadastral data sets: modelling is complex
- There are problems in data dissemination in a distributed environment which is a condition in case data are maintained by (many) different organisations
- Lack of a shared set of concepts and terminology in the Cadastral Domain



Technology push vs. Market pull

- Geo-ICT developments: Modeling standards, Database technology, Positioning systems, Internet development, Wireless communication
à **Geometry is in mainstream ICT**
- User requirements of Cadastral systems change over time, due to: Change in legislation, Governmental policy, New tasks for the organization, New technology
- Therefore, generic and flexible systems needed à **Model Driven Architecture** based on conceptual models described in UML



Scope and motivation for a standardized Cadastral Domain Model

- Covers both land registry and cadastre
- Main advantages:
 1. Avoids re-implementing same functionality again, and provides a basis extensible model driven approach
 2. Facilitate cadastral data exchange between in-country organizations and between countries
- Design goals: model should be as simple as possible, transparent and modular



Model independent of organisation, examples of actual registrations

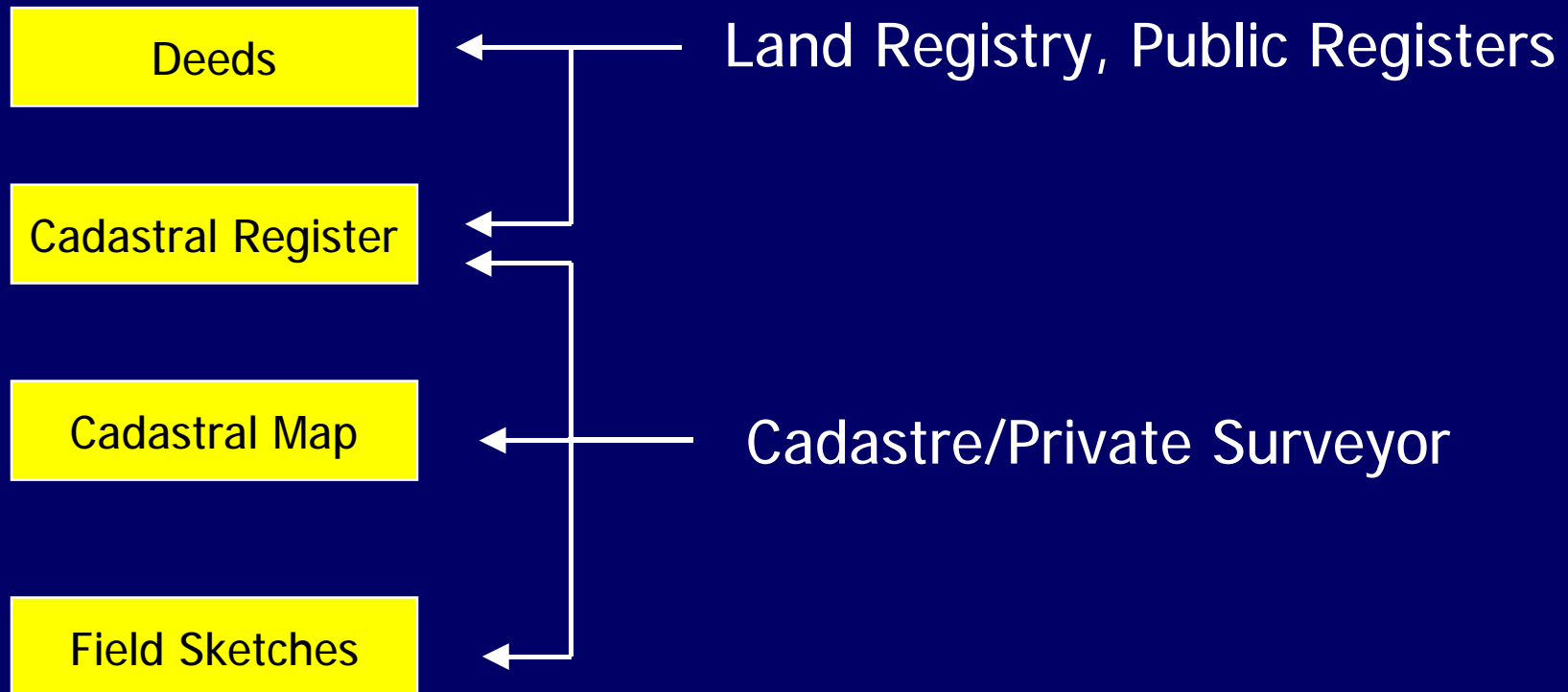

Customer Groups: cadastral data exchange

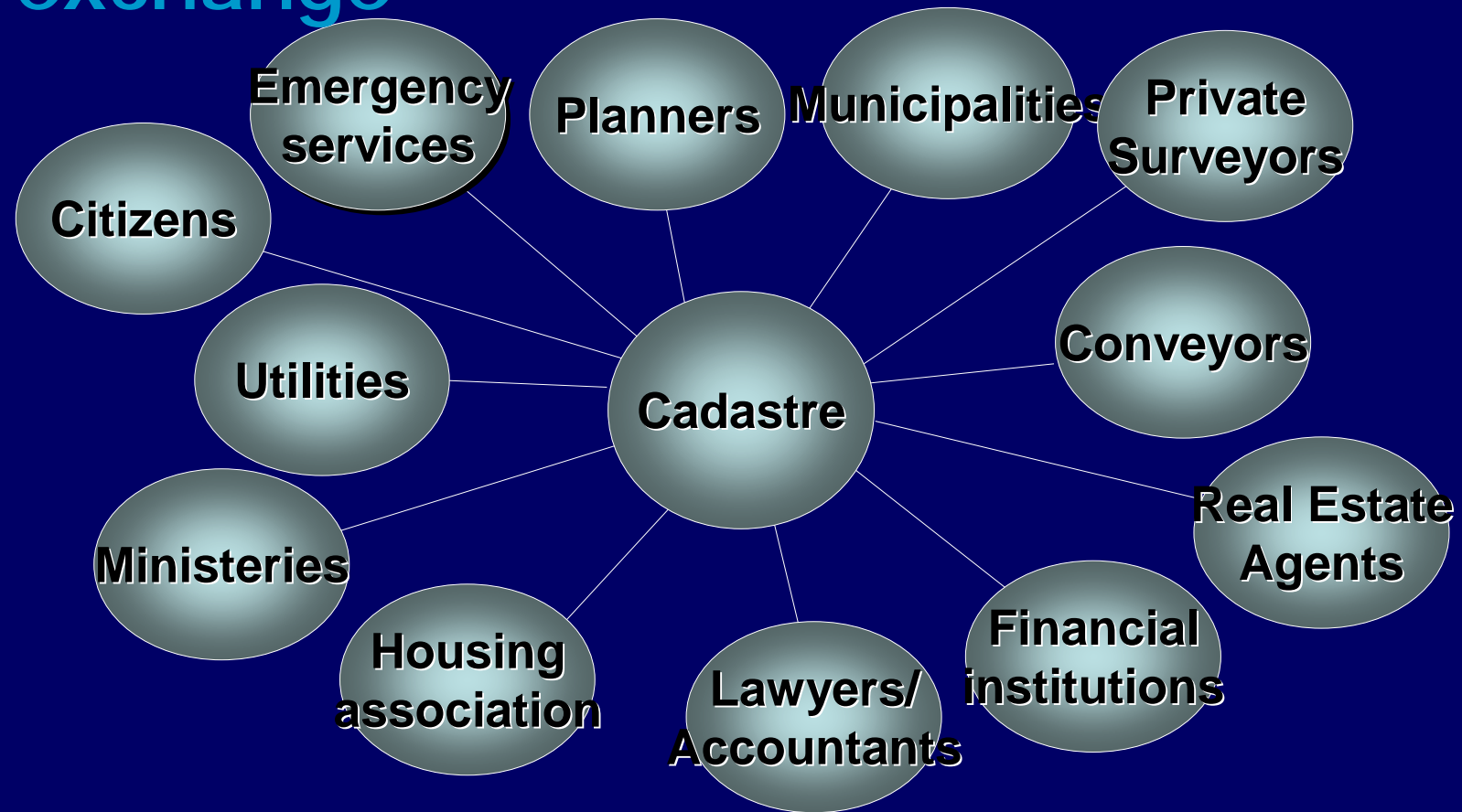

Some other (related) initiatives

- ArcCadastre (Sweden)
- Intergraph
- Caris
- LandXML used *Landonline* of the LINZ (New Zealand)
- Australian ASDI 'cadastral model'
- COST G9 'modeling real estate transactions' (European research network)



Some other (related) initiatives: Modeling standards ISO in Germany (Seifert 2002)

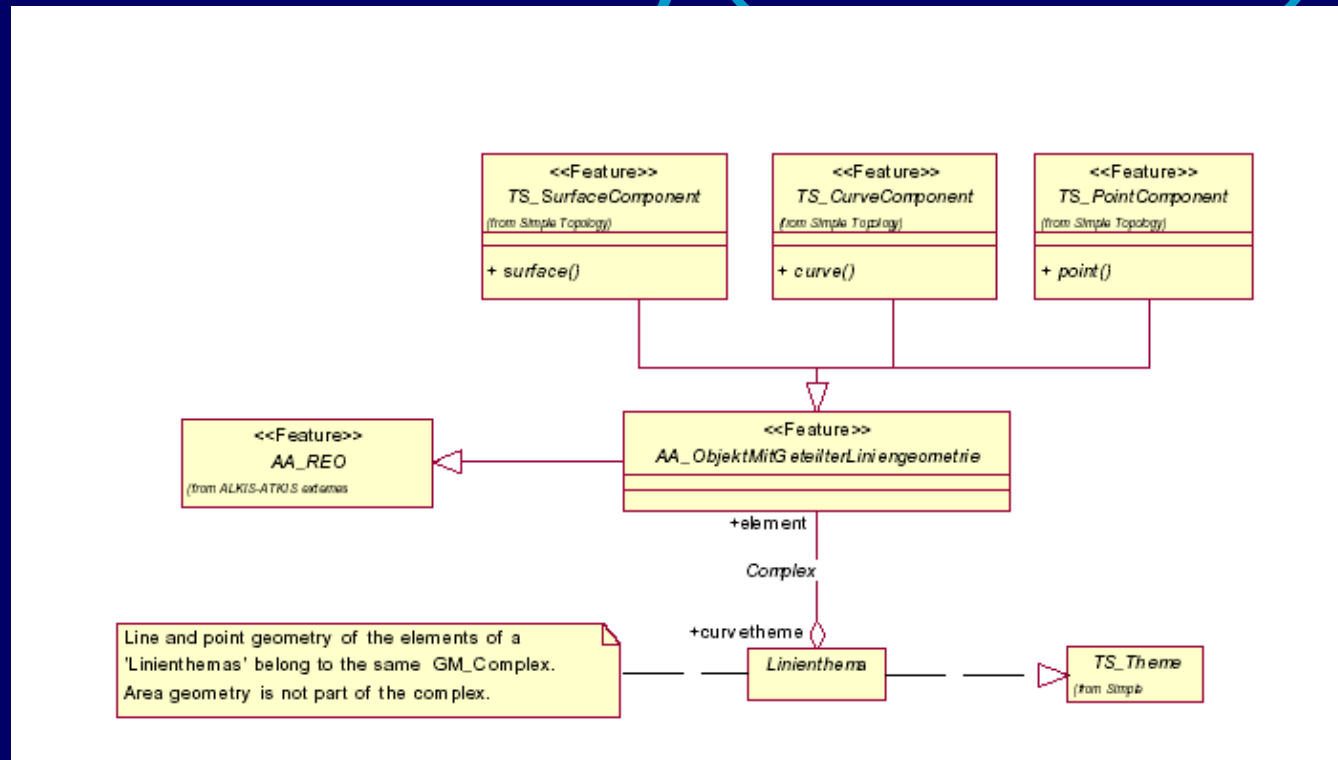

Some other (related) initiatives: Modeling standards US NILS

- BLM & USDA Forreast service developed National Integrated Land System (NILS)

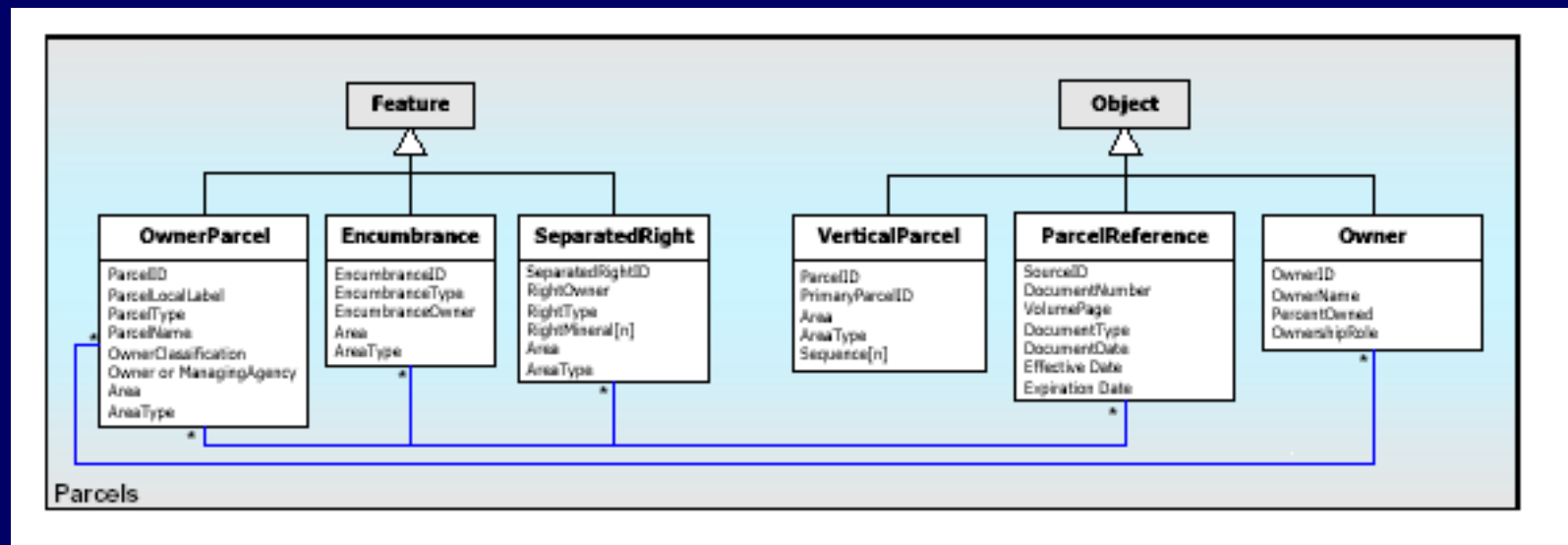

Based on ArcGIS Parcel Data Manager (von Meyer et al)

Some other (related) initiatives: Modeling standards Sweden/EULIS

Initiative for EULIS (first admin data distr.):

- Landmäteriet, Sweden
- National Land Survey, Finland
- HM Land Registry, (for England, Wales)
- Registers of Scotland
- State Land Cadastre (Lithuania)
- Kadaster, the Netherlands
- Ministry of Justice, Austria
- Norsk Eiendominformasjon, Norway
- University of Lund, Sweden



NL data-model

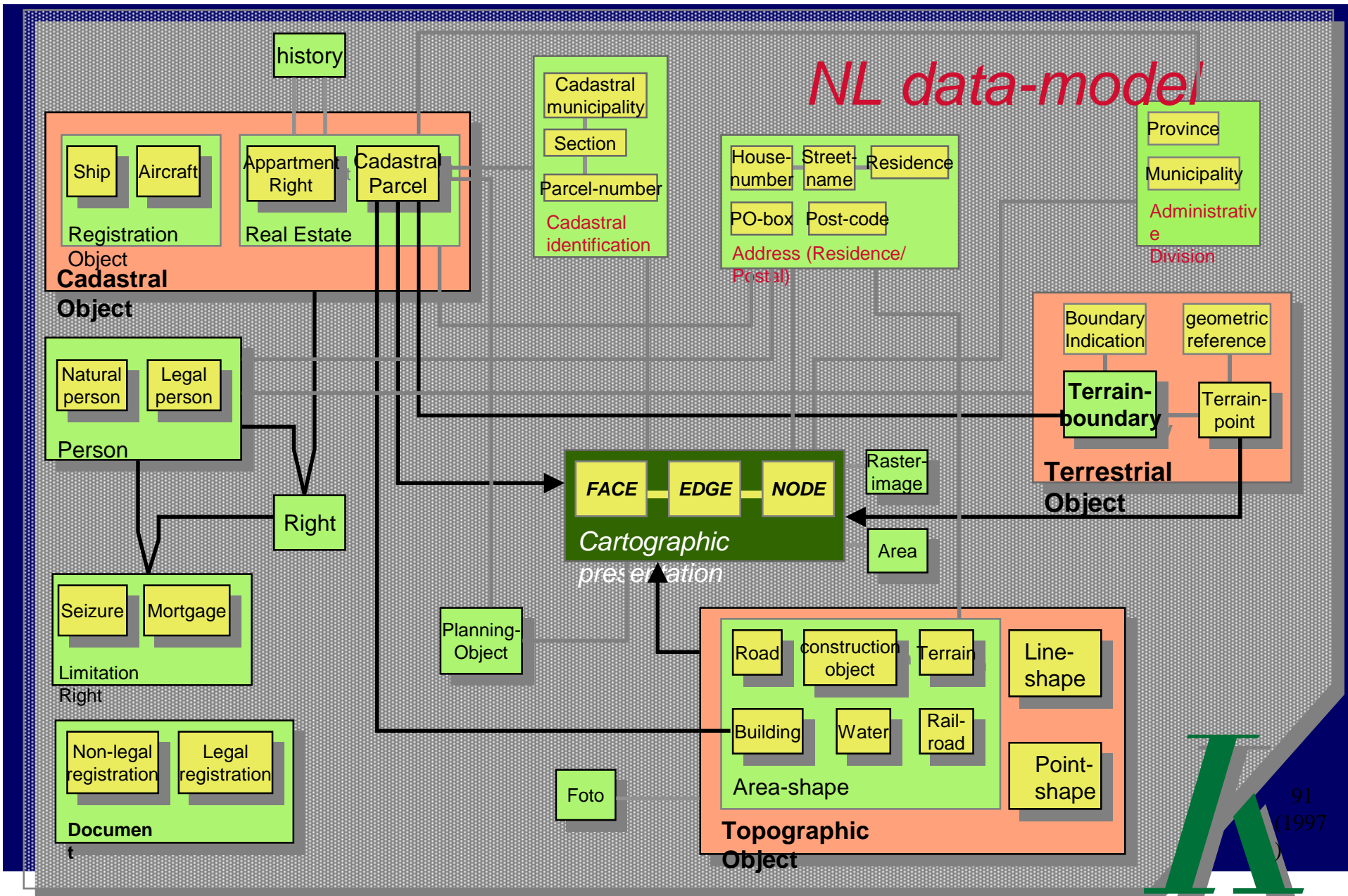

DATA CONTENTS OF THE
REAL PROPERTY REGISTER

Immovable items:

- land plots;
- constructions;
- flats in multi-flat houses;
- premises.

Cadastral data about
immovable item

- ü Data identifying a property object;
- ü Qualitative and quantitative characteristic of property object;
- ü Main objective purpose of use;
- ü Other.

Map of the Real
Property Register

Graphical data about the boundaries of a registered immovable item, its location and position in the national co-ordinate system

Real rights in
immovable items and
data about the
holders of these rights

- ü Ownership right;
- ü Right of entrust;
- ü Right of possession;
- ü Servitude;
- ü Usufruct;
- ü Right to build-up;
- ü Long-term lease;
- ü Lien;
- ü Mortgage;
- ü Other real rights.

- ü First and family name of a physical person;
- ü Personal code;
- ü Name of a legal entity, its code;
- ü Address;

Legal facts related
to immovable items,
real rights in them
and restrictions
on these rights

- ü Sale-purchase contract;
- ü Contract on exchange;
- ü Contract of gift;
- ü Contract of lease;
- ü Contract of enjoyment;
- ü Contract of rent;
- ü Other legal facts.

Agenda

- Introduction
- Cadastral Data
- Generic Cadastral Domain Model
- Conclusions



Basic datamodel

1. Parcel
2. Apartment
3. Building
4. Spatial Unit

One Point

Lines

Polygon (low accuracy)

Polygon (high accuracy)

Quality labels

1. Formal Ownership
2. Customary
3. Indigenous
4. Tenancy
5. Starter, landhold, freehold
6. Possession
7. Mortgage
8. Usufruct
9. Long Lease
10. Restriction Type 1
11. Restriction Type 2
12. State
13. Informal
14. Unknown
15. Disagreement
16. Occupation
17. Uncontrolled privatisation
18. Conflict

Overlap

1. Natural Person
2. Company
3. Municipality
4. Co-operation
5. Group
6. Ministry

Biometric identification

CONTINUUM OF RIGHTS

Legal or formal rights

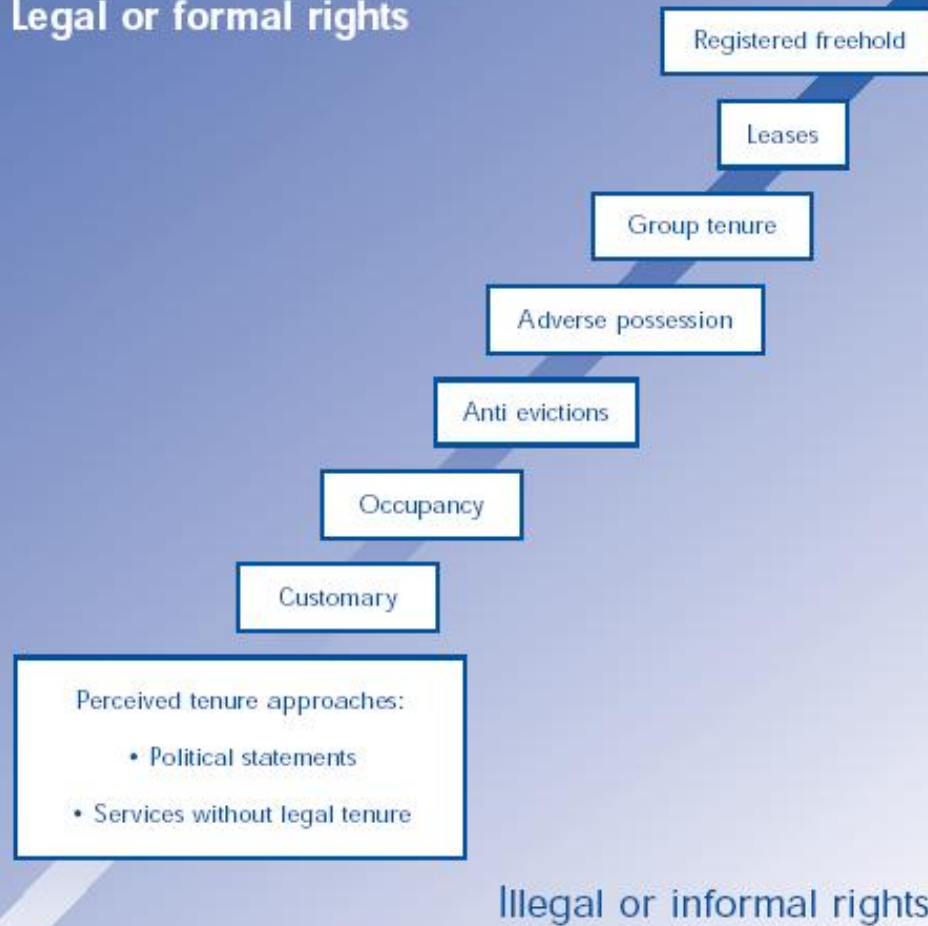

Cadastral Data

- object (parcel, apartment, spatial unit)
- right (ownership (...,...), usufruct, mortgage, restriction, informal, unknown, conflict...)
- person (natural, non natural, group, group of groups)
- identifiers
 - value
 - Area (GIS area and legal area)
 - classification
 - geographic name
 - person name
 - date (birth, establishment, acceptance, transaction, survey, check-in)
 - ranking order
- source document
- forms
 - point
 - boundary
 - face, edge, node: topology
 - GIS Layers
 - apartment - 3d
 - land use
 - share
 - transaction type
 - purchase price
 - history (check-in, check-out, mother-child, history class)
 - right relation
 - mortgage, interest



Cadastral Update Process Data

•Transactions

- Customers request (application)
- Quality (accuracy, reliability, collection mode)
- Name of Conveyor, Surveyor, etc
- Signature
- Process step
- Archive data in use
- Next open identifier
- Type of instrument
- Distance in km
- Letters to buyer and seller
- Car in use, fuel
- Date and time
- Site
- Buyer/seller do not agree
- Authorisation
- Computer availability
- Topological errors
- Production norm
- Time registration
- Objection, complaint
- Salary scale
- Team
- Teammembers
- Responsible manager
- Status code
- Out of tolerance
- Line code
- Point code
- Transformation parameters
- Historical data used
- Cluster identifier
- IT Support



Agenda

- Introduction
- Cadastral Data
- Generic Cadastral Domain Model
- Conclusions



Proposal (FIG Washington 2002)

- Develop standard Core Cadastral Domain Model, including:
 - Spatial part (geometry, topology)
 - Extensible frame for legal/admin part
 - Based on core **object-right-subject** model
- Object-orientation à express in UML
- Accepted by large community: FIG, OGC, ISO, user support, this means it can be **adapted by the industry**
- Maximize co-operation, minimize double effort



Core Cadastral Domain Model - history

- FIG April 2002, Washington, proposal by Lemmen/ van Oosterom: Core Cadastral Domain Model
- Now part of FIG working plan 2002-2006
- Several versions produced: OGC TC Noordwijk, sept'02; FIG WW Paris, apr'03; Digital Earth Brno, sept'03; FIG WW Cairo, apr'05
- 2 FIG workshops: Enschede, mar'03; Bamberg, dec'04
- Involved organizations: FIG, EU COST G9, OGC, ISO
- FIG October 2006, Munich: version 1...



Model basis: Object-Right-Subject

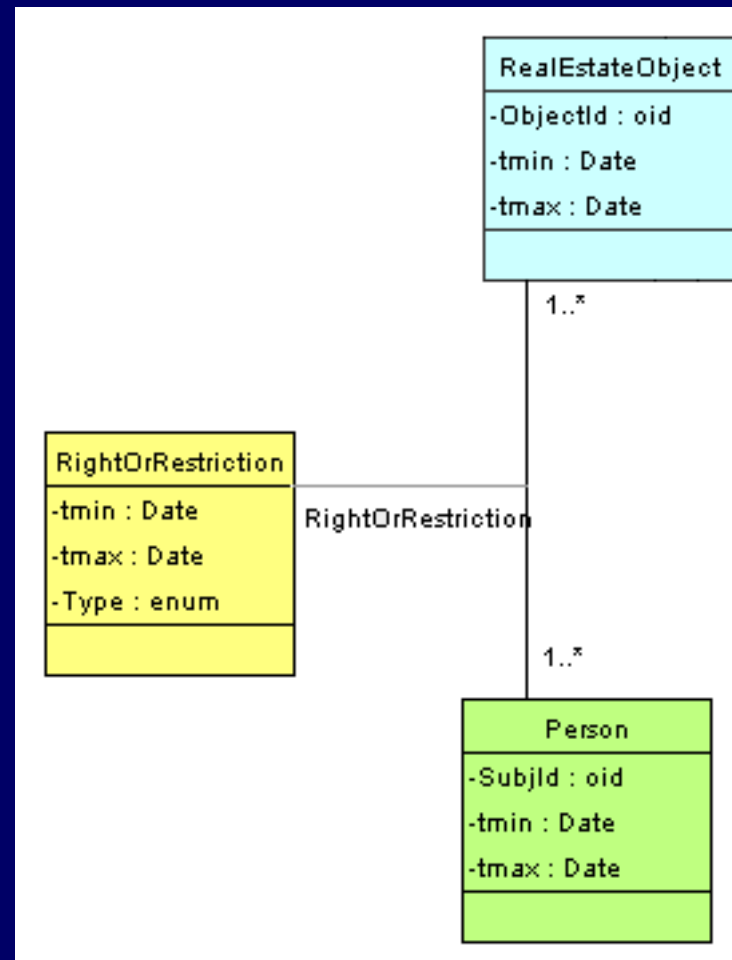

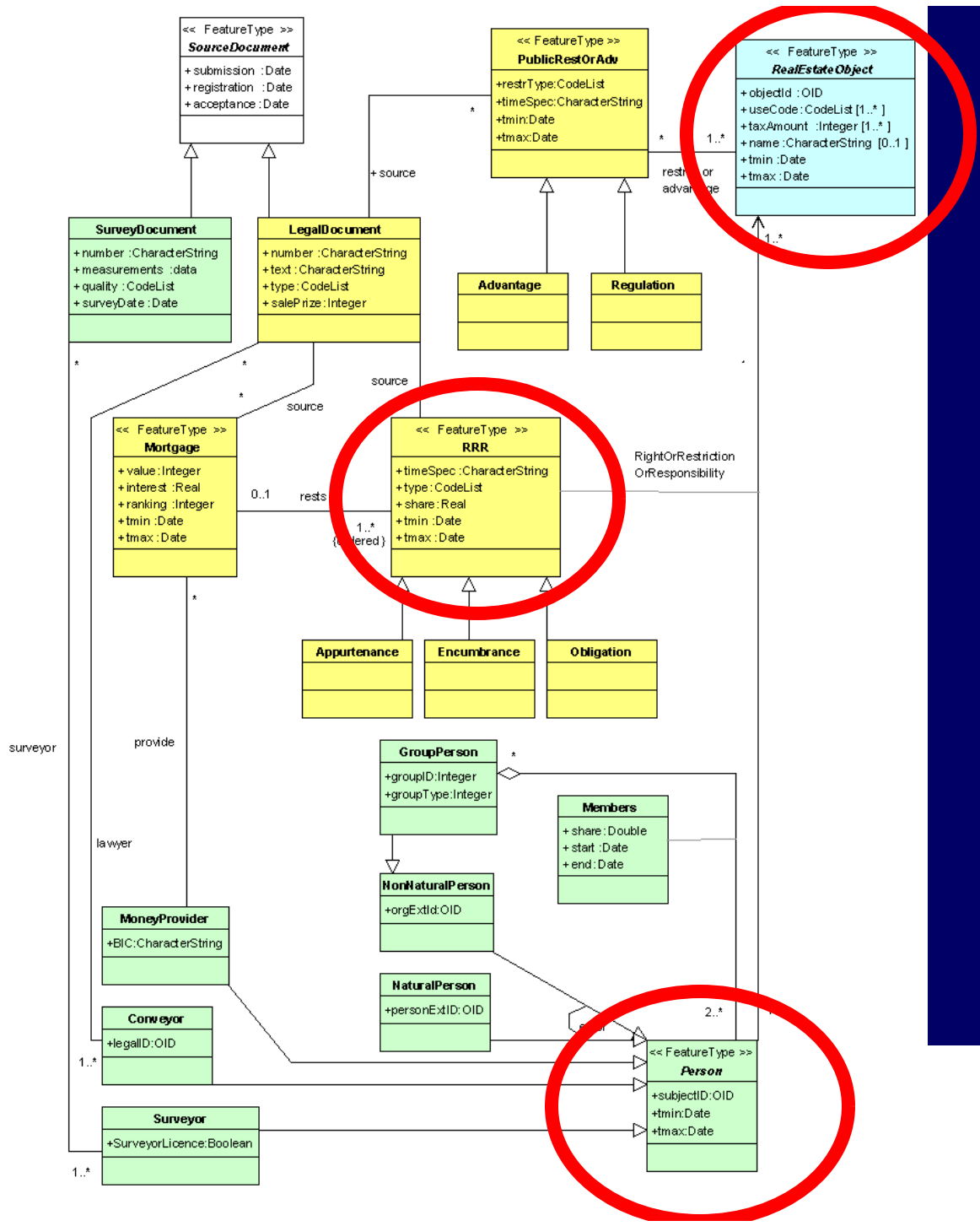

Core Cadastral Domain Model: Geometry

- Real estate object with specialisations, e.g. parcel, parcel-complex, volume property, restriction area, point parcel, apartment unit, based on topological structure or not
- Agregations like parcels set, parcel complex, apartment complex
- Link to surveying and survey documentation
- Link to OGC standards (Nodes, Edges and Faces)



Core Cadastral Domain Model: Legal-administrative

- RRR is an association class between Person and RealEstateObject
- Mortgage, restriction and RRR are based on legal documents or decisions
- Person are specialised as natural or non natural
- Surveyor, conveyor and money provider are included, specialisations of the Persons class
- A RRR can be temporal

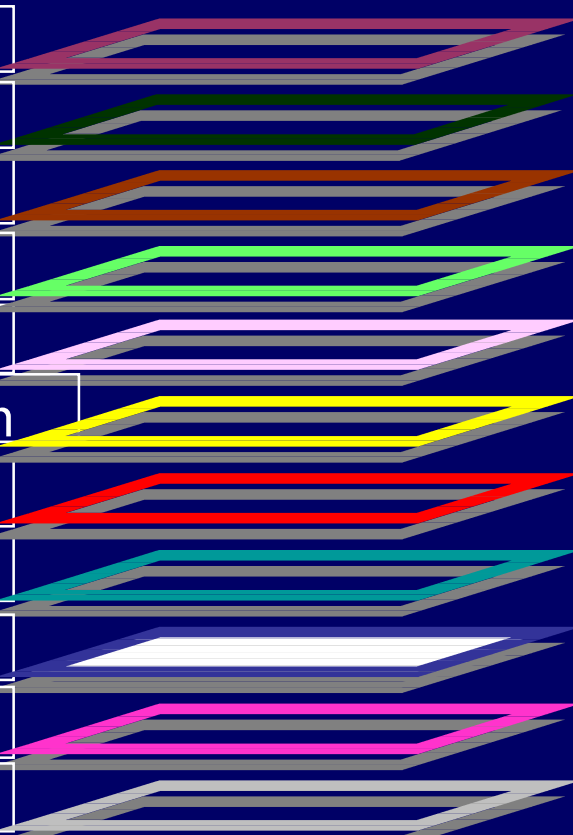

FIG Cadastre 2014 (Kaufmann, Steudler)

Legal Topics:

-
- Resource Exploitation
- Collective Rights
- Water Protection
- Indigenous Rights
- Environment Protection
- Land Use Planning
- Land Property
- Shelter and Housing
- Natural Resources
- Natural Land Objects

Land Object Boundaries:



Rightful Claimants:

-
- Chartered company
- Corporation
- Society
- Tribe, Clan
- Society
- Society
- Private Land Owners
- House owners
- Society
- Society



FIG Cadastre 2014 approach is integrated

- Cadastre 2014 is a generic, very good, abstract set of guidelines (compare to ISO standard, or OGC abstract specification)
- CCDM is refined into a more specific model using UML (compare OGC implementation specification)
- CCDM is based on OGC and ISO TC211 standards
- CCDM will enable interoperable implementations and provide foundation for database structure (DBMS DDL/SQL), information exchange format (XML/GML)



Boundary of the system – outside (in this moment):

- Geology, geo-technical, soil
- Pipelines and cables
- Polluted area registers
- Mining right registers
- Cultural history
- (Religious) monuments
- Ship/airplane (car) registers
- ...



Aspects not yet covered

- Processes: how to maintain consistency between two related distributed systems in case of updates: the cadastral production process depends on availability and quality of data at remote servers (e.g. Persons in population database)
- Catalogues with 'types of right' (per country?)
- Further modelling of cadastral survey
- Inclusion of a range of spatial units
- Generation of a full XML/GML schema
- Test with real data, in EULIS context
- Harmonise with other domain models, e.g. Topography, Water, Utility Networks



Agenda

- Introduction
- Cadastral Data
- Generic Cadastral Domain Model
- Conclusions



Conclusion

- Current proposal is under development, workshops, reviews, etc
- More attention to process side (in addition to data side)
- Not only the model itself is important, but the fact that there is consensus (also important role of industry)



Thank you

- www.fig.net
- www.oicrf.org
- www.gdmc.nl



Model independent of organisation, examples of actual registrations

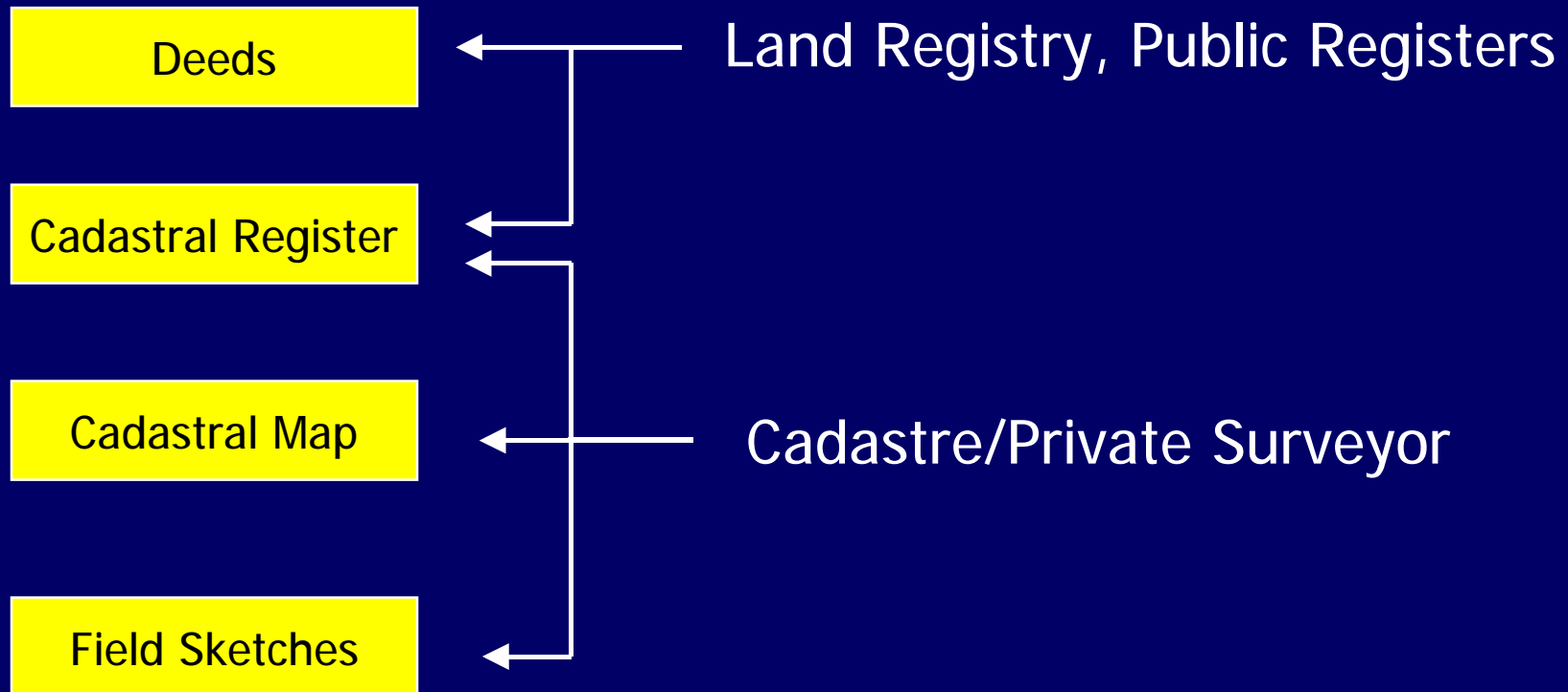

Customer Groups: cadastral data exchange

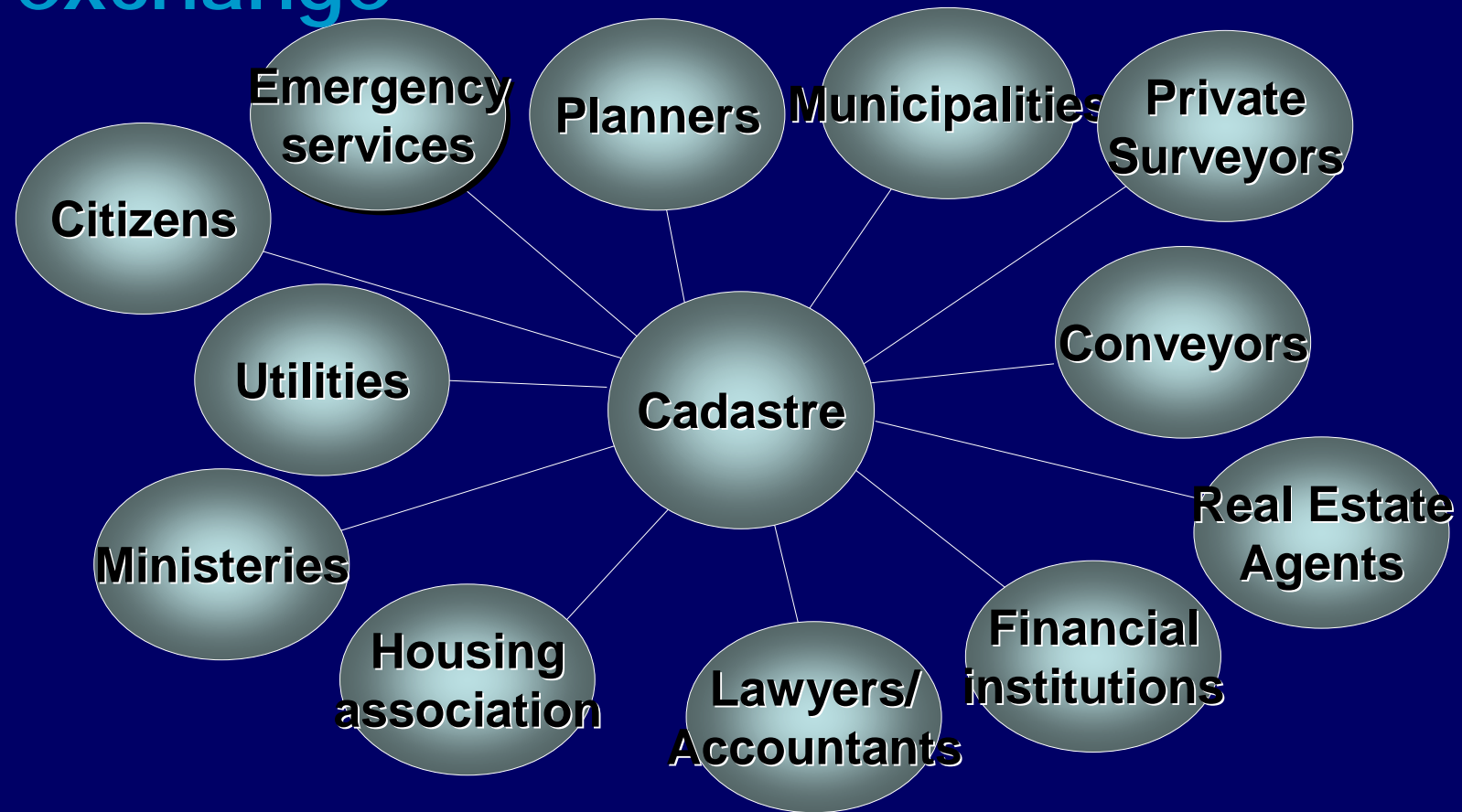

History and dynamic aspects, data

- Two modeling approaches for discrete changes:
 1. **Event based** modeling: transactions as entity, start state is known, changes are known
 2. **State based** modeling: states are modeled explicitly, objects have 2 dates (begin/end)
- In our model hybrid approach: documents represent the transactions, but also all the states are kept
- **tmin/tmax** attributes inherited from root objects
- No explicit **parent-child** relationships (lineage), implicit



History and dynamic aspects, processes

- Other type of UML diagram used to model the processes (e.g. use case, sequence, collaboration, state or activity diagrams).
- Example of splitting a parcel described in a **state diagram**

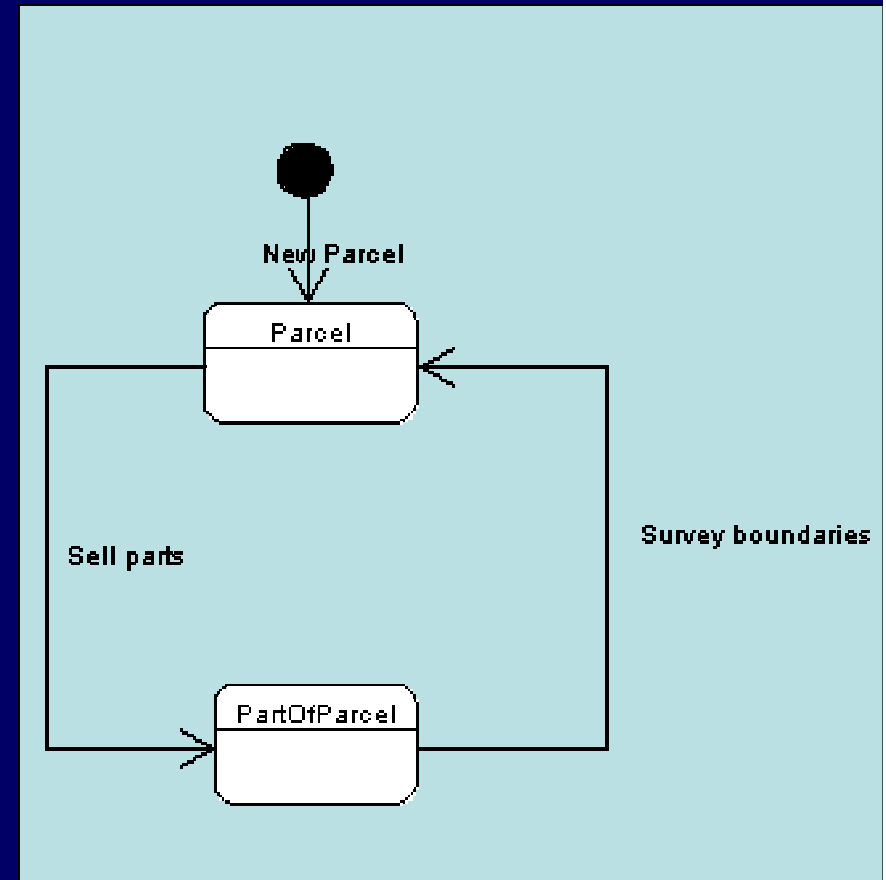

3D example in NL, current 'solution'

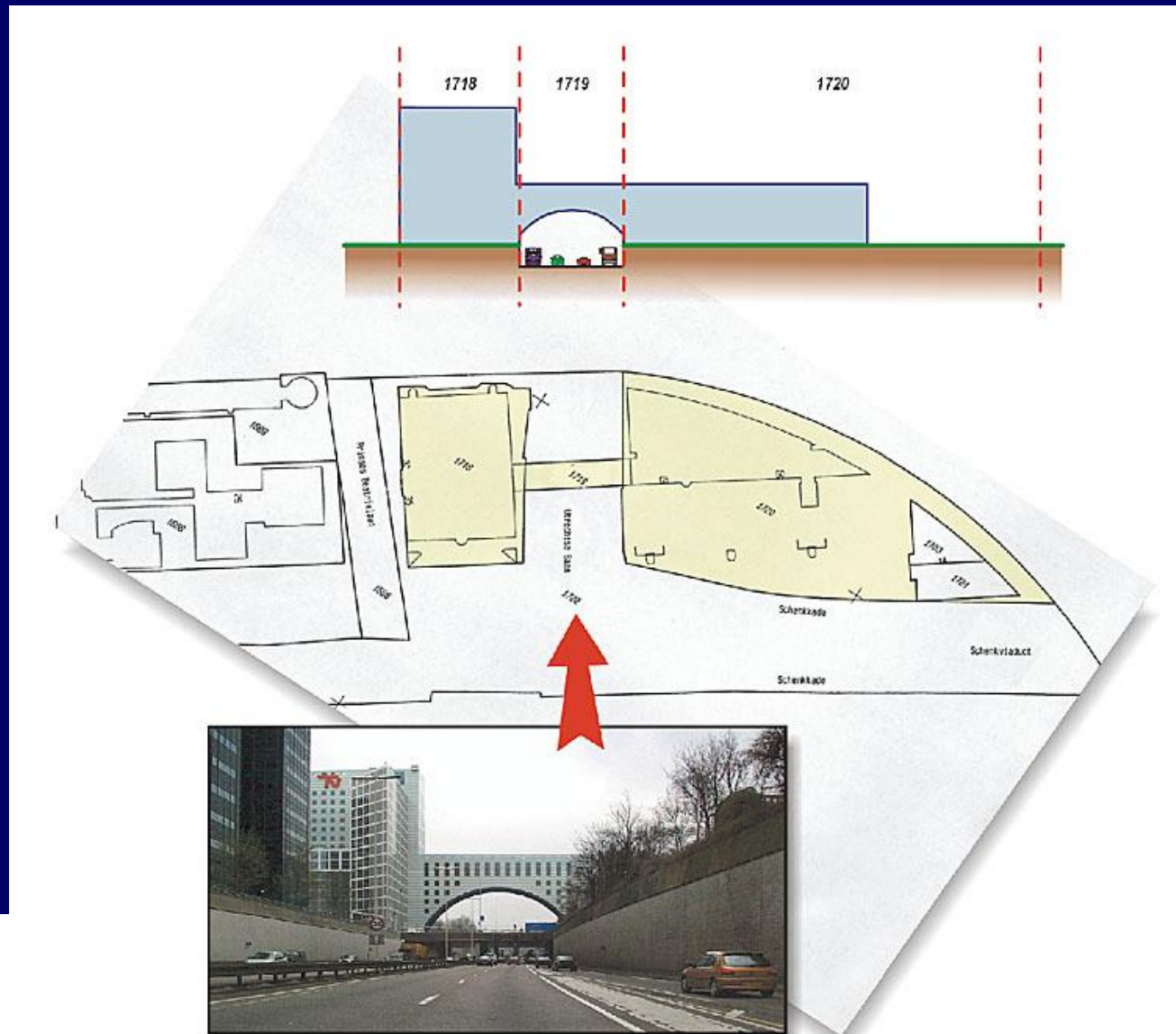

3D Parcel of one building is subdivided into 3 parts with different admin tags

Registration of 3D object (tunnel)

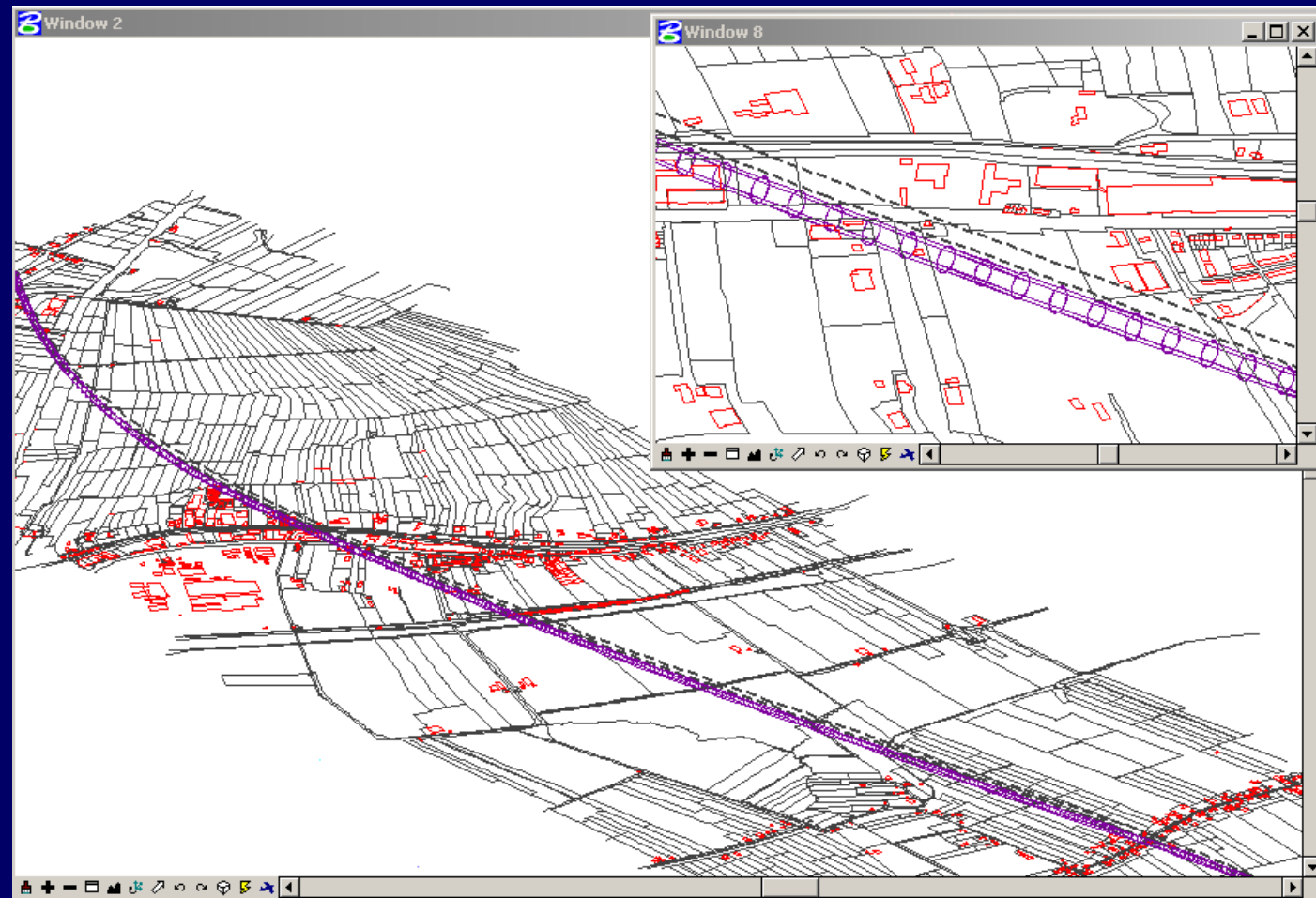

Another 3D factual situation (NL)

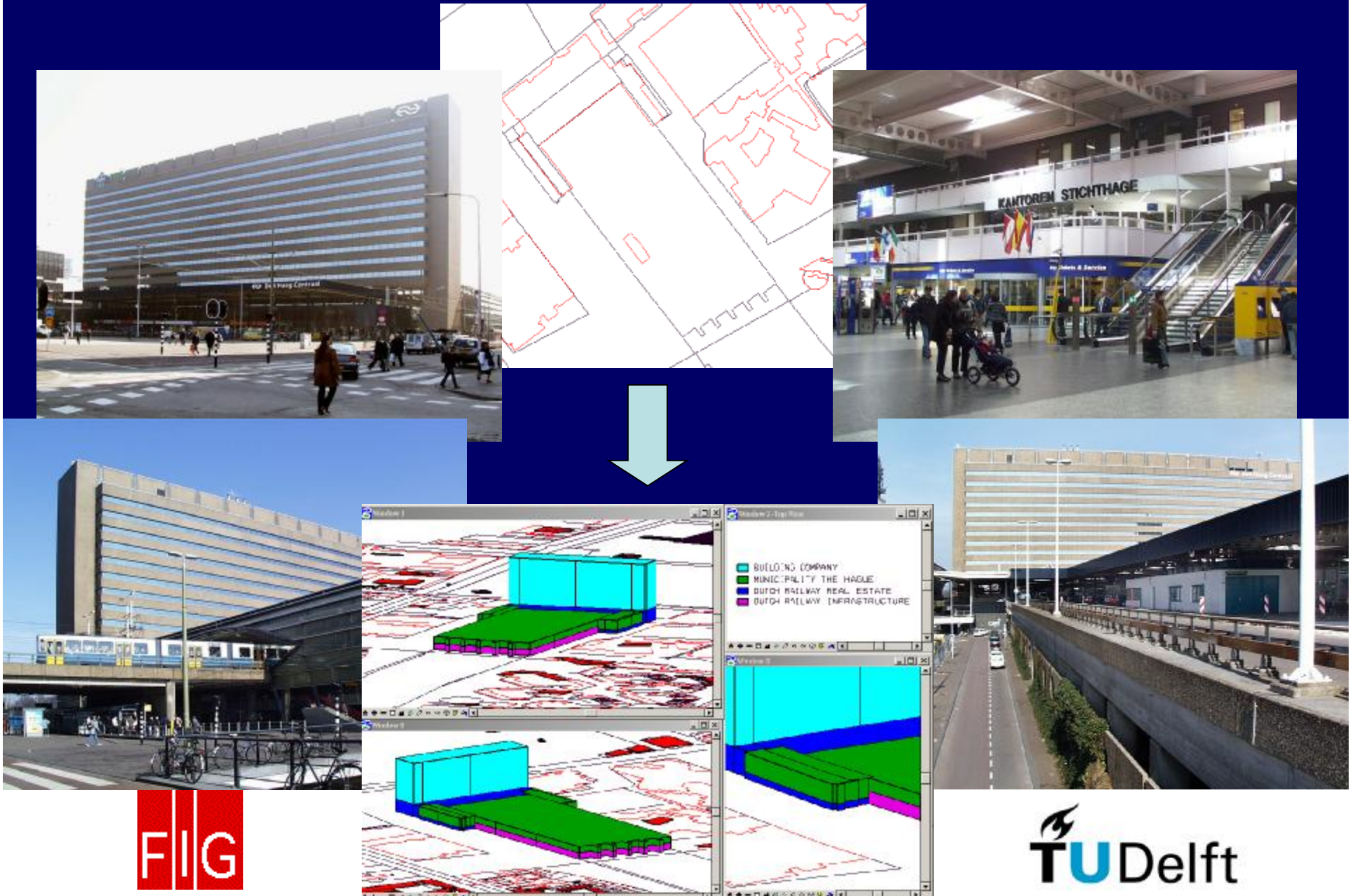

3D appartement complex on 2D parcels

